

# TRADITIONAL 3" CABINET DRAWER PULL

## Model # HTP-0300



### PRODUCT DESCRIPTION

- 3" wide on center.
- Solid brass construction.
- Includes mounting hardware.

- Break to length screws
- Fits materials from 1/2" to 1-1/2" thick

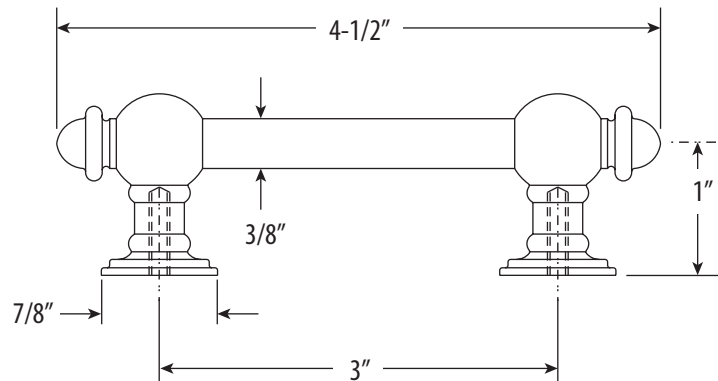

DIMENSIONS MAY VARY AND ARE SUBJECT TO CHANGE. NO RESPONSIBILITY IS ASSUMED FOR USE OF SUPERCEDED OR VOIDED DATA

### AVAILABLE IN 32 FINISHES

Almond - 01	Black Nickel - BLN	Distressed Antique Copper - DAC	Polished Gold - PG	Brass - UPB
Antique Brass - AB	Black-Oil Rubbed Bronze - ORB	Distressed American Bronze - DAMB	Polished Nickel - PN	Venetian Bronze - VB
Antique Bronze - ABZ	Biscuit - 07	Distressed Antique Pewter - DAP	Satin Chrome - SC	Weathered Brass - WB
Antique Copper - AC	Caribbean Bronze - CB	Euro-White - EW	Satin Gold - SG	Weathered Copper - WC
American Bronze - AMB	Chocolate Bronze - CHB	Matte Black - MB	Satin Nickel - SN	White - WT
Antique Pewter - AP	Chrome - CH	Polished Brass - PB	Tuscan Brass - TB	
Black - 06	Distressed Antique Brass - DAB	Polished Copper - PC	Unlaquered Polished	